

CERTIFICATE OF LOCATION OF GOVERNMENT CORNER

Northeast Corner of Section 10, Township 105, Range 41, 5th P.M.

STATE OF MINNESOTA, County of MURRAY

At the corner location shown on the sketch:

- On 5-24-77 found a 9"x10" Stone With "+" Down 4.5' With a 2"x2"x18" Wood Hub
DATE
Over
 - left monument as found, lowered monument, removed monument (explain)
- On 5-24-77 placed a 3/4"x24" Iron Rod Down 0.3' Over Stone
DATE

SKETCH OF REFERENCE TIES

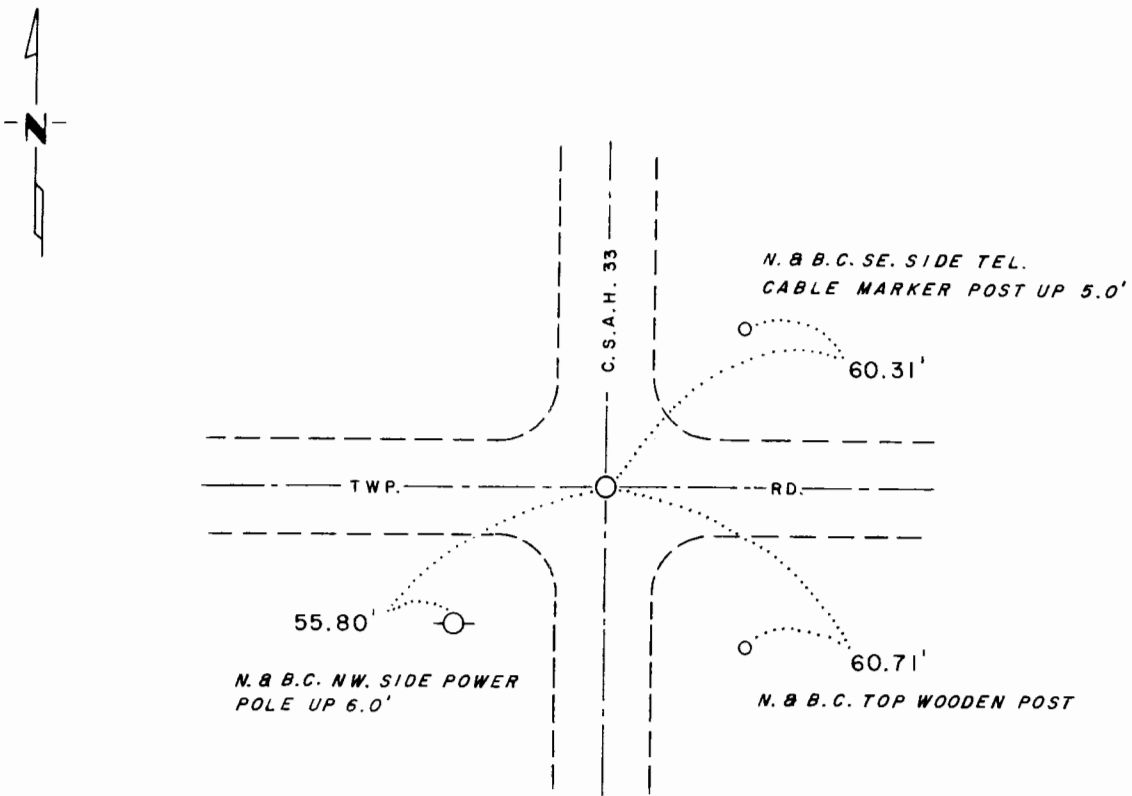

Statement of evidence relative to this corner location is on back of page.

I hereby certify that this document and the data contained herein was prepared by me or under my direct supervision.

Gay A. Stevenson 7-3-78
SIGNATURE DATE

Registration No. 12684

Land Surveyor, Professional Engineer

County Surveyor, County Engineer

OFFICE OF THE REGISTER OF DEEDS

County of _____

I hereby certify that this document was filed in the Reg. of Deeds office at _____ .M. on the _____ day of _____ A.D., 19 ____

Register of Deeds _____

By _____, Deputy

DOCUMENT NO. _____

Statement of Evidence:

Northeast Corner Sec. 10 T 105 - R 41

Murray County

This corner was originally established by the U.S. General Land Office survey in 1861. The government notes show corner marked with a wood post set in mound of earth with pits and trench dug around the mound.

In May, 1977 the DNR Bureau of Engineering contracted the Murray County Offices of the Recorder, Auditor and Engineer for corner information.

Information found in the section book at the Engineer's office was a survey by J. W. Woolstencroft of Section 10 in R 01. He shows a stone with "+" at this corner and ties to fence corners NE, SE, SW and NW. Also on this page is written that the DNR set iron pipe at this corner and gives ties.

In 1957, the DNR assumed this corner at the road intersection.

In 1970, we found this assumed corner and set an iron pipe.

On May 24, 1977, we found this iron pipe with a R.R. spike inside at the road intersection. Because of the record of a stone being set at this corner, we hired Sidney Pope to dig for this stone with his backhoe. We found a 9" x 10" stone with "+" down 4.5' with a 2" x 2" x 18" wooden hub over. The stone was 8" below an old road bed. We set a 8" x 9" x 16" stone over the other stone and the hub was laid beside it. A 3/4" x 24" iron rod was set over the stone at the surface. The iron pipe and the R.R. spike were removed.

SS

164266

State of Minnesota, }
County of Murray, } SS

I hereby certify that the within instrument
was filed in this office for record on the
7th day of August A.D. 19 81,

at 8:30 o'clock A M., and was duly re-
corded as Microfilm Document No. 164266

Willard W. Ohme
County Recorder